

07/06/2011



103628363

ET

To the Director of the U.S. Patent and Trademark Office, record the attached documents or the new address(es) below.

1. Name of conveying party(ies)

DALE M. DONNELLY, EXECUTOR OF THE ESTATE OF DEWAYNE PATRICK DONNELLY, DECEASED

Additional name(s) of conveying party(ies) attached? Yes No

2. Name and address of receiving party(ies)

Name: DALE M. DONNELLY

Internal Address: _____

Street Address: 1451 VAQUERO DRIVE

City: SIMI VALLEY

State: CALIFORNIA

Country: UNITED STATES Zip: 93065

Additional name(s) & address(es) attached? Yes No



3. Nature of conveyance/Execution Date(s):

Execution Date(s) May 27, 2011

- Assignment Merger
- Security Agreement Change of Name
- Joint Research Agreement
- Government Interest Assignment
- Executive Order 9424, Confirmatory License
- Other _____

4. Application or patent number(s):

This document is being filed together with a new application.

A. Patent Application No.(s)

B. Patent No.(s)

US 6,820,365 B1

Additional numbers attached? Yes No

5. Name and address to whom correspondence concerning document should be mailed:

Name: DALE M. DONNELLY

Internal Address: _____

Street Address: 1451 VAQUERO DRIVE

City: SIMI VALLEY

State: CALIFORNIA Zip: 93065

Phone Number: 805-630-5288

Fax Number: _____

Email Address: DALEMAN@ROADRUNNER.COM

6. Total number of applications and patents involved: ONE (1)

7. Total fee (37 CFR 1.21(h) & 3.41) \$40.00

- Authorized to be charged to deposit account
- Enclosed
- None required (government interest not affecting title)

8. Payment Information

Deposit Account Number i

Authorized User Name 07/06/2011 AMILLINS 00000008 6820365

01 FC:0021 40.00

9. Signature:

Dale M. Donnelly
Signature

5-27-11
Date

DALE M. DONNELLY, EXECUTOR
Name of Person Signing

Total number of pages including cover sheet, attachments, and documents:

5

Documents to be recorded (including cover sheet) should be faxed to (571) 273-0140, or mailed to:
Mail Stop Assignment Recordation Services, Director of the USPTO, P.O.Box 1450, Alexandria, V.A. 22313-1450

7-6-11

ASSIGNMENT OF PATENT

DALE M DONNELLY is the executor of the Estate of DEWAYNE PATRICK DONNELLY. DEWAYNE PATRICK DONNELLY invented an artificial fishing lure with interconnecting tumblers, for which a United States Patent was granted on November 23, 2004, Patent No. US 6,820,365 B1. DALE M. DONNELLY, as executor of the Estate of DEWAYNE PATRICK DONNELLY does, without consideration, transfer and assign to DALE M. DONNELLY all its right, title, and interest in and to the above-referenced Patent. This Assignment is effective immediately.

DATED: 5-27-11

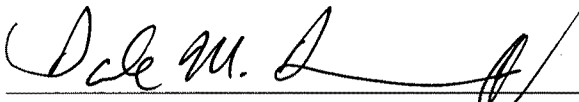

DALE M. DONNELLY, Executor of the
Estate of DEWAYNE PATRICK
DONNELLY



US006820365B1

(12) United States Patent
Donnelly

(10) Patent No.: **US 6,820,365 B1**
(45) Date of Patent: **Nov. 23, 2004**

(54) ARTIFICIAL FISHING LURE WITH INTERCONNECTING TUMBLERS

(76) Inventor: Dewayne Donnelly, 1226 Patricia St., #3, Simi Valley, CA (US) 93065

(*) Notice: Subject to any disclaimer, the term of this patent is extended or adjusted under 35 U.S.C. 154(b) by 0 days.

(21) Appl. No.: 10/465,720

(22) Filed: Jun. 18, 2003

(51) Int. Cl.: A01K 85/12

(52) U.S. Cl.: 43/42.12; 43/42.14

(58) Field of Search: 43/42.12, 42.13, 43/42.14

(56) References Cited

U.S. PATENT DOCUMENTS

1,313,476 A	8/1919	Ewert	
1,842,127 A	1/1932	Stickel et al.	
1,997,802 A	4/1935	Meyer	
2,389,423 A	* 11/1945	Evans	43/42.12
2,467,151 A	4/1949	Nordquist	
2,526,077 A	10/1950	Jurczok	

2,688,205 A	*	9/1954	Brown	43/26.2
2,714,778 A		8/1955	Megerle	
4,135,323 A	*	1/1979	Esten	43/42.16
4,881,341 A	*	11/1989	Dickey et al.	43/42.12
4,891,901 A	*	1/1990	Baker, Jr.	43/42.11
5,050,334 A	*	9/1991	Standish, Jr.	43/42.13
6,018,901 A	*	2/2000	DuBois	43/42.19
6,176,035 B1	*	1/2001	Somogyi	43/42.14

* cited by examiner

Primary Examiner—Michael J. Carone

Assistant Examiner—Bret Hayes

(74) *Attorney, Agent, or Firm*—Jack C. Munro

(57) ABSTRACT

An artificial fishing lure which has a pair of interconnected tumblers. The tumblers are to rotate when the fishing lure is moved through water which is to be an attractant to a fish to induce striking of the lure. By the interconnecting of the tumblers, the tumblers are always rotated at the same speed but in opposite directions thereby balancing the movement of the tumblers on the lure assuring that the lure always moves in an upright position through the water and does not turn over which would twist the fishing line to which the lure is attached.

4 Claims, 1 Drawing Sheet

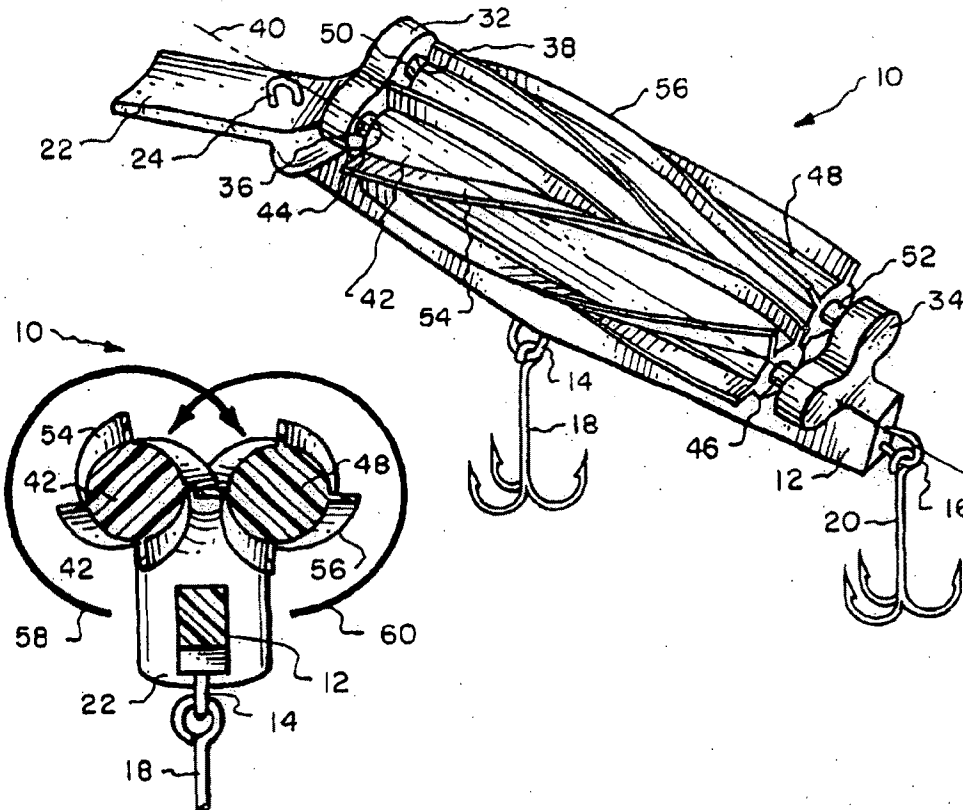

PATENT